

NEW
series
EIGHT

8 Pressure Gauge

Regal
Model: 8S SF30

The New Series8 is a high quality pressure gauge designed to meet a wide range of general industrial and engineering applications such as process, chemical, petrochemical, mining and power stations.

The SF30 pressure gauge has a solid front, stainless steel case for use when operation safety is a requirement. It is liquid filled to minimize the effects of vibrations or pulsations and is suitable for use on corrosive media that would normally attack brass units.

Specifications

Dial Size	Connection	Accuracy
63mm (2.5")	¼" BSPP, BSPT or NPT	±1.6%
100mm (4")	? ", ½" BSPP, BSPT or NPT	±1.0%
150mm (6")	? ", ½" BSPP, BSPT or NPT	±1.0%

Restrictor Screw standard on all connections

Mounting

- L Direct Lower (Bottom)
- B Direct Center Back
- N Direct Lower Back
- R Surface Lower (Bottom) with Back Flange
- V Flush Center Back with Front Flange
- W Flush Lower Back with Front Flange
- U Flush Center Back with U-clamp

Scale Ranges

- 0 to 60 kPa up to 100,000 kPa
- 100/0 kPa Vacuum.
- 100/60 kPa up to 2400 kPa compound.

Options: Scales available in Bar, PSI, dual scales or to customers request.

Pressure Element

316 Stainless Steel Bourdon tube.

Overload Accuracy

130% of the range.

Accuracy Class

1.0% as per EN 837-1
Option: 0.5% as per EN 837-1 (150mm only)

Environmental Rating

IP67

Operating Temperature

Ambient -40 up to +60°C
Medium +100°C maximum

Case

304 Stainless Steel, liquid fillable



Bezel

DIN Bayonet bezel

Window

Laminated Safety Glass

Dial

White Anodised Aluminium marked in black

Pointer

Black pointer
Options: Micro adjustable pointers
Min or Max pointers

Movement

304 Stainless Steel

Case Filling

Glycerine
Option: Silicone Oil

Safety

All gauges designed and manufactured in accordance with EN 837-1. All cases are fitted with a blow-out vent. Features a Solid Front and Stainless Steel Blow out Back.

Installation Instructions

Refer to EN 837-2

Options

Cleaning for Oxygen and other hazardous materials
Electrical Contacts

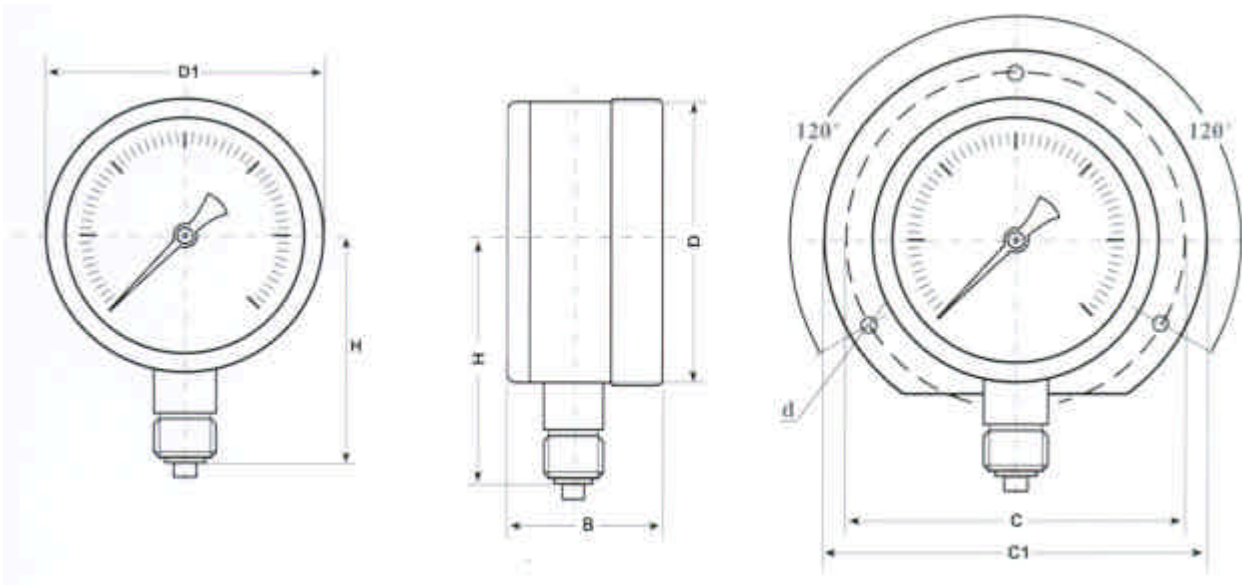

Dial Size	D	D1	H	B	C	C1	d
63mm (2.5")	63	64	57	40	Ø77	Ø85	Ø3.5
100mm (4")	99	101	83	50	Ø118.5	Ø128	Ø5
150mm (6")	159	161	124	50	Ø161	Ø181	Ø5

Ordering Specification for Model 8S SF30

Dial Size

63mm	63
100mm	10
150mm	15

Mounting

Direct Bottom	L
Direct Center Back	B
Direct Lower Back	N
Surface Bottom Back Flange	R
Flush Center Back Front Flange	V
Flush Lower Back Front Flange	W
Flush Center Back U Bracket	U

Connection Type & Size

Code	NPT	Code	BSPP parallel	Code	BSPT taper
2	1/2"	2B	1/2"	2T	1/2"
3	? "	3B	? "	3T	? "
4	1/4"	4B	1/4"	4T	1/4"
8	? "	8B	? "	8T	? "
X	None of the above, customer special request				

Scale Type

Pressure	P
Vacuum	V
Compound	C

Graduation

Range	100 (example only)
Unit	kPa, Bar, PSI, dual scale

Custom Dials on request

Options

Dual Scale	X
Oxygen Clean	G
Refrigeration Scale	R
Temperature Scale	T

Specifications and details are accepted E&OE and subject to change without notice



JCB INSTRUMENTS PTY LTD

ABN 60 003 986 034
 P O Box 262
 497 Wentworth Avenue
 Toongabbie NSW 2146

Telephone: (612) 9896 8833
 Facsimile: (612) 9896 8500
 Web: www.jcbinst.com.au
 Email: sales@jcbinst.com.au